

# Data sheet

|             |   |
|-------------|---|
| ID          | <b>CB 2 WH</b>  |
| Description | through box   |
| Properties  | Circular box for surface installation with 2 mounting lugs, standard mounting screw spacing 50.8mm (2") for conduit diameters 20mm to 25mm, with brass inserts M 4, without lid |
| Colour      | white, similar to RAL 9010  |

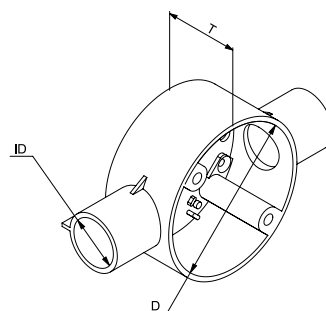

|                     |                           |          |
|---------------------|---------------------------|----------|
| Working temperature | Degree of protection (IP) | UV-Level |
| -5 to +60 °C        | IP3X                      | L2       |

| Art. no. | Dimensions Ø/LxB x T | For tube diameter | Small Package | Large Package |
|----------|----------------------|-------------------|---------------|---------------|
| 009 275  | 65 x 32 mm           | 20 mm             | 25 pc         | 200 pc        |
| 009 277  | 65 x 32 mm           | 25 mm             | 25 pc         | 200 pc        |

## Further technical details

| Details                      |                |
|------------------------------|----------------|
| Halogen free                 | False          |
| Tackable                     | False          |
| Number of inlets             | 2              |
| Type of housing feed-through | Pipe socket    |
| Equipped with                | None           |
| Cover model                  | Mounting cover |
| Explosion-tested version     | False          |
| Weatherproof                 | False          |
| Material                     | PVC-U          |

\*) L1: Indoor use - to avoid UV discoloration (no exposure to direct sunlight).

L2: Partially shaded: Outside, in areas with sun only for two to four hours a day, in shadowy places.

L3: Full sun: To be used also in areas with whole-day exposure to sunlight, e. g. roofs, antenna poles or PV panels.

Civil engineering and road construction products marked "L2" have to be laid in the shortest time possible to ensure color fastness and stability.

All figures refer to standardised test samples and are given to our best knowledge but without further commitment. It is Univolt's belief that information set forth in this Data Sheet is accurate, Univolt makes no warranty, expressed or implied, with respect thereto and disclaims any liability from reliance thereon. All data are subject to change without prior notice.