

ATEX reduction adaptors, metric-metric

ATEX Reduzierungen, metrisch-metrisch

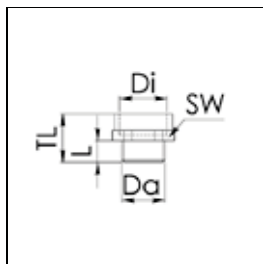

Form A

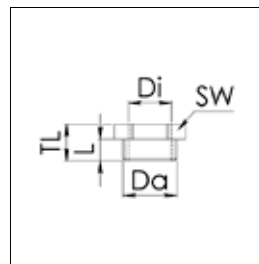

Form B



Explosion protection: II 2 G Ex e II
II 2 D Ex tD A21 IP66
Certificates: PTB 04 ATEX 1040 X
Protection class to EN 60 529: IP 66
Temperature range: -20°C to 70°C
Material: Polyamide, reinforced glass fibre

Explosionsschutz: II 2 G Ex e II
II 2 D Ex tD A21 IP66
Bescheinigungen: PTB 04 ATEX 1040 X
Schutzart gemäß EN 60 529: IP 66
Einsatztemperatur: -20°C bis 70°C
Material: Polyamid, glasfaserverstärkt

Type	WISKA-No. RAL 9005		 Da	 Di			TL	Form
			mm	mm	mm	mm	mm	
EX-KRM 16/12	10064720	100	M 16x1,5	M 12x1,5	9	20	27	A
EX-KRM 20/12	10064721	100	M 20x1,5	M 12x1,5	9	24	16	B
EX-KRM 20/16	10064722	100	M 20x1,5	M 16x1,5	9	24	27	A
EX-KRM 25/12	10064723	100	M 25x1,5	M 12x1,5	10	29	17	B
EX-KRM 25/16	10064724	100	M 25x1,5	M 16x1,5	10	29	17	B
EX-KRM 25/20	10064725	100	M 25x1,5	M 20x1,5	10	29	17	B
EX-KRM 32/16	10064726	50	M 32x1,5	M 16x1,5	12	36	19	B
EX-KRM 32/20	10064727	50	M 32x1,5	M 20x1,5	12	36	19	B
EX-KRM 32/25	10064728	50	M 32x1,5	M 25x1,5	12	36	19	B
EX-KRM 40/20	10064729	25	M 40x1,5	M 20x1,5	12	46	19	B
EX-KRM 40/25	10064730	25	M 40x1,5	M 25x1,5	12	46	19	B
EX-KRM 40/32	10064731	25	M 40x1,5	M 32x1,5	12	46	19	B
EX-KRM 50/20	10064732	5	M 50x1,5	M 20x1,5	14	55	21	B
EX-KRM 50/25	10064733	5	M 50x1,5	M 25x1,5	14	55	21	B
EX-KRM 50/32	10064734	5	M 50x1,5	M 32x1,5	14	55	21	B
EX-KRM 50/40	10064735	5	M 50x1,5	M 40x1,5	14	55	21	B
EX-KRM 63/20	10064736	5	M 63x1,5	M 20x1,5	15	68	22	B
EX-KRM 63/25	10064737	5	M 63x1,5	M 25x1,5	15	68	22	B
EX-KRM 63/32	10064738	5	M 63x1,5	M 32x1,5	15	68	22	B
EX-KRM 63/40	10064739	5	M 63x1,5	M 40x1,5	15	68	22	B
EX-KRM 63/50	10064740	5	M 63x1,5	M 50x1,5	15	68	22	B